

ORDINANCE NO. 4085

AN ORDINANCE OF THE CITY OF KIRKLAND RELATING TO ZONING AND LAND USE AND AMENDING THE CITY OF KIRKLAND ZONING MAP (ORDINANCE 3710 AS AMENDED) TO CONFORM TO THE COMPREHENSIVE PLAN AND TO ENSURE CONTINUED COMPLIANCE WITH THE GROWTH MANAGEMENT ACT, FILE NO. ZON06-00009 AND APPROVING A SUMMARY FOR PUBLICATION.

WHEREAS, the Growth Management Act (GMA), RCW 36.70A.215, mandates that the City of Kirkland review, and if needed, revise its official Zoning Map pursuant to RCW 36.70A.130; and

WHEREAS, the Zoning Map implements the Comprehensive Plan (Ordinance 3481 as amended); and

WHEREAS, the City Council included a clause in Ordinance 4080 adopted on December 12, 2006, to consider amendments to the Kirkland Zoning Map no later than February 20, 2007, as part of the 2006 Comprehensive Plan process, to consider needed to changes in zoning for park use and low density residential use for the proposed land exchange between Mark Twain Park and Parcel No 3326059178 at 10522-130<sup>th</sup> Ave NE; and

WHEREAS, the City Council has received a recommendation from the Kirkland Planning Commission to amend a portion of the City of Kirkland Zoning Map, Ordinance 3710, as set forth in that certain report and recommendation of the Planning Commission dated January 25, 2007, and bearing Kirkland Department of Planning and Community Development File No. ZON06-00009; and

WHEREAS, prior to making the recommendation, the Planning Commission, following notice thereof as required by RCW 35A.63.070, held a public hearing on January 25, 2007, on the amendment proposal; and

WHEREAS, pursuant to the State Environmental Policy Act (SEPA), there has accompanied the legislative proposal and recommendations a SEPA Addendum to Existing Environmental Documents issued by the responsible official pursuant to WAC 197-11-600(4); and

WHEREAS, in regular public meeting the City Council considered the environmental documents received from the responsible official, together with the report and recommendation of the Planning Commission; and

NOW, THEREFORE, BE IT ORDAINED by the City Council of the City of Kirkland as follows:

Section 1. Map Amended: The official City of Kirkland Zoning Map as adopted by Ordinance 3710 is amended in accordance with Exhibits A attached to this ordinance.

Section 2. Official Map Change: The Director of the Department of Planning and Community Development is directed to amend the official City of Kirkland Zoning Map to conform with this ordinance, indicating thereon the date of the ordinance passage.

# Exhibit A

## North Rose Hill Neighborhood Zoning Map Change

0-4085

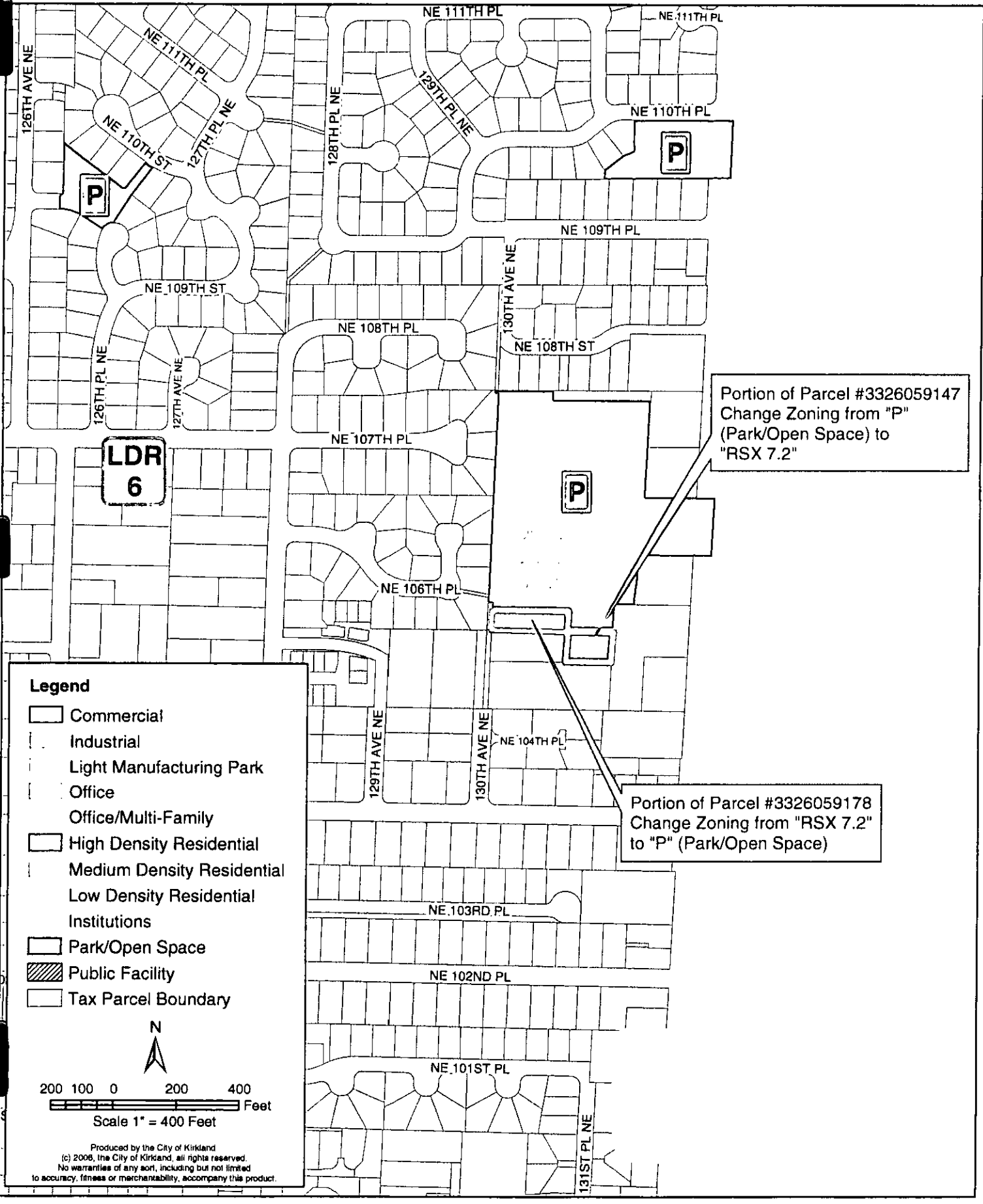

Portion of Parcel #3326059147  
Change Zoning from "P"  
(Park/Open Space) to  
"RSX 7.2"

Portion of Parcel #3326059178  
Change Zoning from "RSX 7.2"  
to "P" (Park/Open Space)

- Legend**
- Commercial
  - Industrial
  - Light Manufacturing Park
  - Office
  - Office/Multi-Family
  - High Density Residential
  - Medium Density Residential
  - Low Density Residential
  - Institutions
  - Park/Open Space
  - Public Facility
  - Tax Parcel Boundary

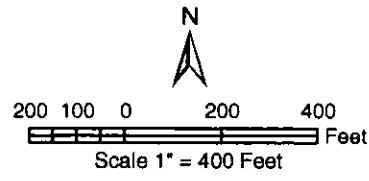

Produced by the City of Kirkland  
(c) 2008, the City of Kirkland, all rights reserved.  
No warranties of any sort, including but not limited  
to accuracy, fitness or merchantability, accompany this product.

Section 3. Severability: If any section, subsection, sentence, clause, phrase, part or portion of this ordinance, including those parts adopted by reference, is for any reason held to be invalid or unconstitutional by any court of competent jurisdiction, such decision shall not affect the validity of the remaining portions of this ordinance.

Section 4. Effective Date: This ordinance shall be in full force and effect five days from and after its passage by the City Council and publication, pursuant to Kirkland Municipal Code 1.08.017, in the summary form attached to the original of this ordinance and by this reference approved by the City Council as required by law.

Section 5. Ordinance Copy: A complete copy of this ordinance shall be certified by the City Clerk, who shall then forward the certified copy to the King County Department of Assessments.

Passed by majority vote of the Kirkland City Council in open meeting this 6th day of February, 2007.

SIGNED IN AUTHENTICATION THEREOF this 6th day of February, 2007.

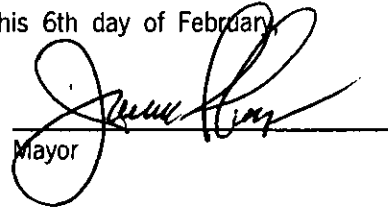
  
\_\_\_\_\_  
Mayor

Attest:

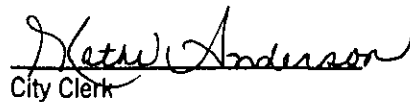
  
\_\_\_\_\_  
City Clerk

Approved as to Form:

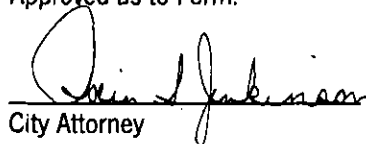
  
\_\_\_\_\_  
City Attorney

PUBLICATION SUMMARY  
OF ORDINANCE NO. 4085

AN ORDINANCE OF THE CITY OF KIRKLAND RELATING TO ZONING AND LAND USE AND AMENDING THE CITY OF KIRKLAND ZONING MAP (ORDINANCE 3710 AS AMENDED) TO CONFORM TO THE COMPREHENSIVE PLAN AND TO ENSURE CONTINUED COMPLIANCE WITH THE GROWTH MANAGEMENT ACT, FILE NO. ZON06-00009.

Section 1. Amends the Kirkland Zoning Map as set forth in Exhibit A.

Section 2. Directs the Director of Planning and Community Development to amend the official Zoning Map.

Section 3. Addresses severability.

Section 4. Authorizes publication of the ordinance by summary, approval of the summary by the City Council pursuant to Kirkland Municipal Code 1.08.017 and establishes the effective date as five days after publication of said summary.

Section 5. Directs the City Clerk, to certify and forward a complete certified copy of this ordinance to the King County Department of Assessments.

The full text of this ordinance will be mailed without charge to any person upon request made to the City Clerk for the City of Kirkland. The ordinance was passed by the Kirkland City Council in open meeting on the 6th day of February, 2007.

I certify that the foregoing is a summary of Ordinance 4085 approved by the Kirkland City Council for summary publication.

  
City Clerk