

ORDINANCE 3379

AN ORDINANCE OF THE CITY OF KIRKLAND DECLARING THE NECESSITY TO TAKE OR DAMAGE FOR PUBLIC USE CERTAIN REAL PROPERTY AND REAL PROPERTY INTERESTS WITHIN THE CITY OF KIRKLAND, IN ORDER TO CONSTRUCT A SANITARY SEWER LINE AS DESCRIBED BY THE 1993 LAKE STREET SEWER REPLACEMENT PROJECT AS AUTHORIZED BY THE KIRKLAND CITY COUNCIL, PURSUANT TO KIRKLAND RESOLUTION 3764.

Be it ordained by the City Council of the City of Kirkland as follows:

Section 1. The City Council finds that the taking and damaging of certain real property and real property interests hereinafter described, is for a public use and necessary to the inhabitants of the City of Kirkland in order to acquire real property and real property interests needed to complete the 1993 Lake Street Sewer Replacement Program, pursuant to Kirkland Resolution 3764 adopting the 1993-1998 Six Year Capital Improvement Program for the City of Kirkland.

Section 2. The real property and real property interests required to be appropriated, taken, or damaged are situate in Kirkland, King County, Washington and specifically described as follows:

Parcel 1

UTILITY EASEMENT

A fifteen foot wide easement being 7.5 feet on either side of the following described centerline:

Commencing at the most northerly corner of the above described tract of land; thence south 48°25'15" west 51.80 feet to the true point of beginning; thence south 34°15'13" east 126.05 feet; thence south 10°30'39" east 48.23 feet to a point on the southerly property line of the above described tract, said point being 21.52 feet south 70°40'24" west from the southeasterly corner of said above described tract and the terminus of said centerline.

TEMPORARY CONSTRUCTION EASEMENT

A twenty-five foot wide easement being 12.5 feet on either side of the following described centerline:

Commencing at the most northerly corner of the above described tract of land; thence south $48^{\circ}25'15''$ west 51.80 feet to the true point of beginning; thence south $34^{\circ}15'13''$ east 126.05 feet; thence south $10^{\circ}30'39''$ east 48.23 feet to a point on the southerly property line of the above described tract, said point being 21.52 feet south $70^{\circ}40'24''$ west from the southeasterly corner of said above described tract and the terminus of said centerline.

Parcel 2

UTILITY EASEMENT

Commencing at the most northerly corner of the above described tract; thence south $70^{\circ}40'24''$ west 110 feet along the northwesterly line to the true point of beginning; thence continuing south $70^{\circ}40'24''$ west along the northwesterly line 20 feet; thence south $31^{\circ}10'54''$ east 49.76 feet to the southeasterly line of said tract; thence north $70^{\circ}40'24''$ east along the southeasterly line 9.05 feet; thence north $18^{\circ}28'11''$ west 48.70 feet to the true point of beginning. (The area of said easement is 707.36 square feet.)

Parcel 3

UTILITY EASEMENT

Commencing at the southwest corner of the above described property; thence north $18^{\circ}28'11''$ west along the east line 16.79 feet to the true point of beginning; thence continuing north $18^{\circ}28'11''$ west along the east line of said property 89.36 feet; thence south $32^{\circ}15'10''$ east 77.99 feet; thence north $61^{\circ}28'07''$ east 55.75 feet to a point which is 16 feet northerly of

the south line of said property; thence south 53°53'42" west along a line which is 16 feet north of and parallel to the south line a distance of 77.09 feet to the east line of said property and the point of beginning. (Said easement contains 1,113.45 square feet).

Compensation and damage awards for the acquisition of said real property and real property interests, shall be paid from proceeds of the City's 1992 water and sewer revenue bonds and from a Public Works Trust Fund Loan administered by the State of Washington Department of Community Development.

Section 3. The Kirkland City Manager is authorized and directed to immediately begin and prosecute action and proceedings in the manner provided by law to purchase, condemn, take, damage, appropriate and otherwise acquire the lands and other property rights and privileges necessary to carry out the purposes of this Ordinance.

Section 4. This Ordinance shall be in force and effect five days from and after its passage by the Kirkland City Council and publication, as required by law.

Passed by majority vote of the Kirkland City Council in regular, open meeting this 3rd day of August, 1993.

Signed in authentication thereof this 3rd day of August, 1993.

MAYOR Pro Tem

Attest:

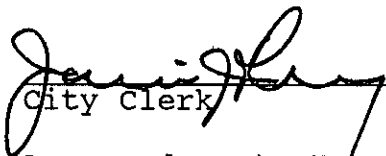
City Clerk

Approved as to Form:

City Attorney

7city93\seweror\slc:nmw

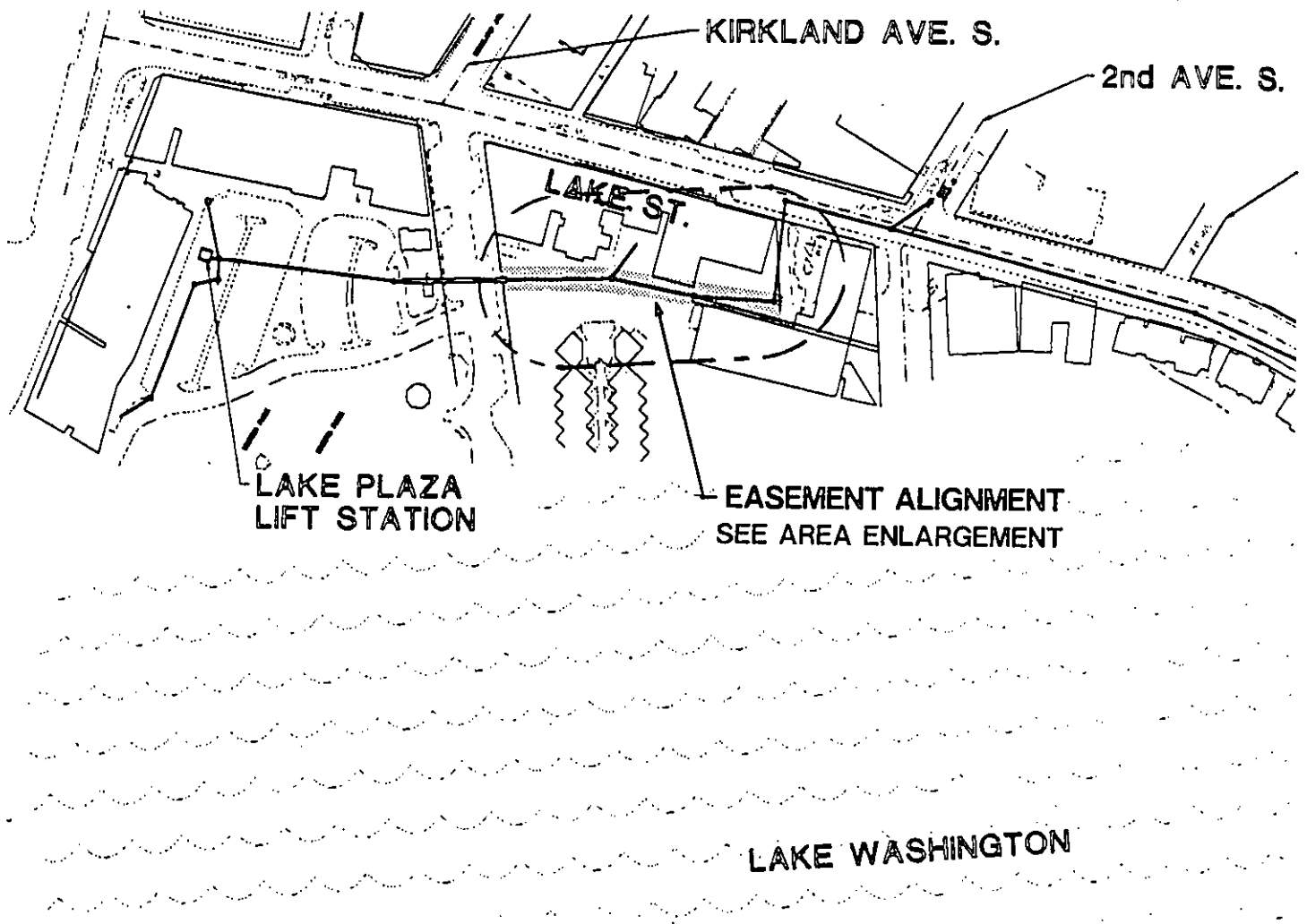

LAKE STREET SEWER LINE REPLACEMENT



CITY OF KIRKLAND

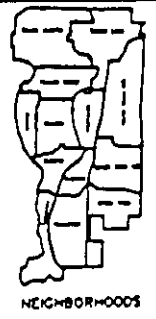

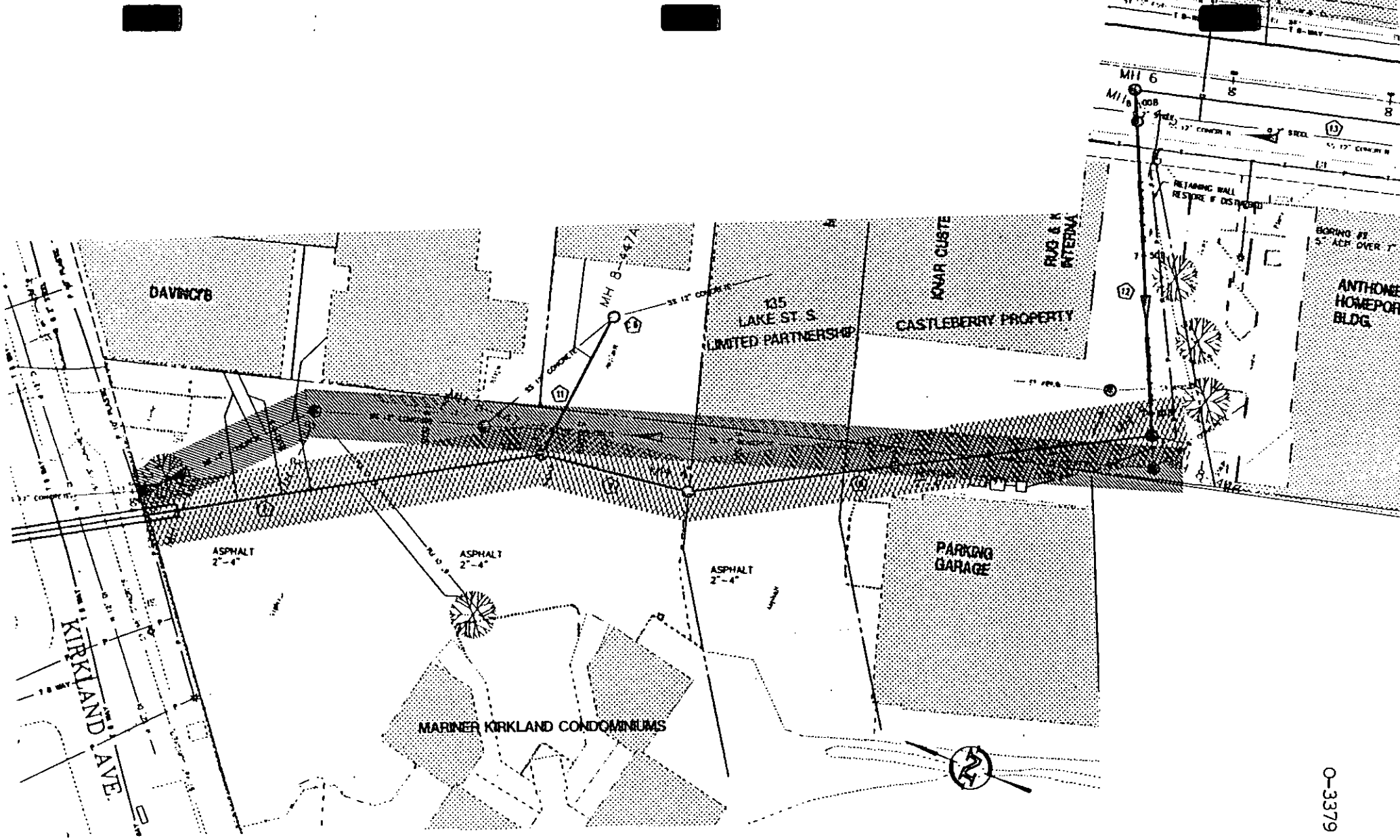

DEPARTMENT: PUBLIC WORKS	Drawn For: PROJECT
PROJECT NO: 07A0002, 02000M	DATE CREATED: 7 APR 1993 BY: DMAYNES
PROJECT: CAPITAL IMPROVEMENTS	DATE REVISION: 7 APR 1993 BY: DMAYNES
LOCATION: CENTRAL WAY TO NE 36TH PLACE	FILE NAME: D:\MAYNES\VCX\PRESS-REA

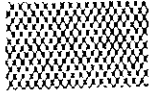

0-3379

LEGEND

-  PROPOSED EASEMENT (15' Width)
-  EXISTING EASEMENT (15' Width)

CITY OF KIRKLAND

LAKE STREET SEWER AREA ENLARGEMENT

DEPARTMENT:	PUBLIC WORKS	Drawn For:	PROJECT
PROJECT NO.:	074002Z_CESS04L	DATE CREATED:	7 Jan 1993
PROJECT:	CAPITAL IMPROVEMENTS	DATE REVISED:	7 Jan 1993
LOCATION:	CENTRAL WAY TO NE 36TH PLACE	FILE NAME:	D:\VMP\SVCL\WSES-MA
		BY:	D:\VMP\SVCL\WSES-MA

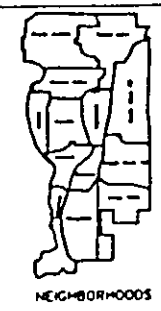

NEIGHBORHOODS