

ORDINANCE NO. 1087

AN ORDINANCE OF THE CITY OF KIRKLAND, WASHINGTON, REZONING CERTAIN PROPERTY DESCRIBED IN PLANNING COMMISSION FILE NO. R-4/67-20, SITUATE IN THE CITY OF KIRKLAND FROM R-4 TO R-3.

WHEREAS, petition was filed for the reclassification of certain property hereinafter specifically described in the Planning Commission File No. R-4/67-20, and subsequently pursuant to proper notice a public hearing was held by the Kirkland Planning Commission on April 20, 1967, and after hearing recommendation was made to the Kirkland City Council recommending such reclassification, and,

WHEREAS, pursuant to proper notice public hearing was then held by the City Council of the City of Kirkland on the 15<sup>th</sup> day of May, 1967,

NOW, THEREFORE, The City Council of the City of Kirkland do ordain as follows:

Section 1. The following specifically described property be, and the same hereby is rezoned from R-4 (motel and cabin courts) to R-3 (multi-family) classification:

The South one-half of Lots 5 and 16, and Lots 6 and 10 through 15, Block 121, Burke & Farrar's Kirkland Addition, Division No. 27, together with Lots 14 through 18, Block 119, Town of Kirkland Addition.  
Location: 1620 Market Street.

Section 2. This Ordinance shall be in force and take effect five (5) days from and after its passage by the Council and publication as required by law.

PASSED by the City Council at regular meeting on the 15<sup>th</sup> day of May, 1967.

SIGNED in authentication thereof on the 15<sup>th</sup> day of May, 1967.

Attest: Allen W. Lucas  
Director of Administration and Finance  
(ex officio City Clerk)  
Approved as to form:  
Raymond  
City Attorney

James L. Dancy  
Mayor

3448

AN ORDINANCE OF THE CITY OF KIRKLAND, WASHINGTON, AMENDING THE COMPREHENSIVE PLAN MAP OF THE CITY OF KIRKLAND, AS ADOPTED IN ORDINANCE NO. 930. (File No. CPA-3/67-17).

WHEREAS, The Kirkland Planning Commission, after public hearing held May 4, 1967, recommended to the Kirkland City Council that the Comprehensive Plan Map for the City of Kirkland be amended as hereinafter set forth, and,

WHEREAS, The City Council of the City of Kirkland, did hold on the 5<sup>th</sup> day of JUNE, 1967, a public hearing to consider said recommendation identified as City of Kirkland File No. CPA-3/67-17, and following said hearing did concur in the recommendation of the Kirkland Planning Commission,

NOW, THEREFORE, Be it ordained by the City Council of the City of Kirkland as follows:

Section 1. The Comprehensive Plan Map of the City of Kirkland as adopted as part of the Comprehensive Plan for the City of Kirkland by Ordinance No. 930 is hereby amended as to the area of the City of Kirkland circled on the map attached to this Ordinance which map by this reference is made a part here of. The area so circled appears on the original of the Comprehensive Plan Map as recommended for service commercial uses, and said recommendation is hereby changed to recommend semi-public uses, all as shown on the attached map.

Section 2. The City Manager is hereby directed to cause this Ordinance and the map attached hereto to be certified and filed with the City Clerk, and with the King County Auditor, in the manner required by law.

Section 3. This Ordinance shall take effect five (5) days from and after its passage by the City Council and publication as required.

PASSED by the City Council in regular meeting on the 4<sup>th</sup> day of JUNE, 1967.

SIGNED in authentication thereof on the 5<sup>th</sup> day of JUNE, 1967.



James L. Vearf  
Mayor

[Signature]  
Director of Administration and Finance  
(ex officio City clerk)

Approved as to form:  
[Signature]  
City Attorney

I hereby certify that the foregoing is a true and correct copy of an Ordinance of the City of Kirkland and that the same was published or posted according to law, said Ordinance being No. 1089 and entitled "An Ordinance as above."  
George E. Anderson City Clerk.

JUN-14 10 44 6 6189588

LST -- RF

30

FILED for Record at Request of

Name CITY OF KIRKLAND - Planning Dept.

Address Main St. & Central Way

KIRKLAND, WASH. 98033

RECORDED 4944 Needs  
VOL .....  
PAGE 465 REQUEST OF

1967 JUN 14 PM 2 08

ROBERT A. MORRIS, AUDITOR  
KING COUNTY WASH.  
RAM DEPUTY

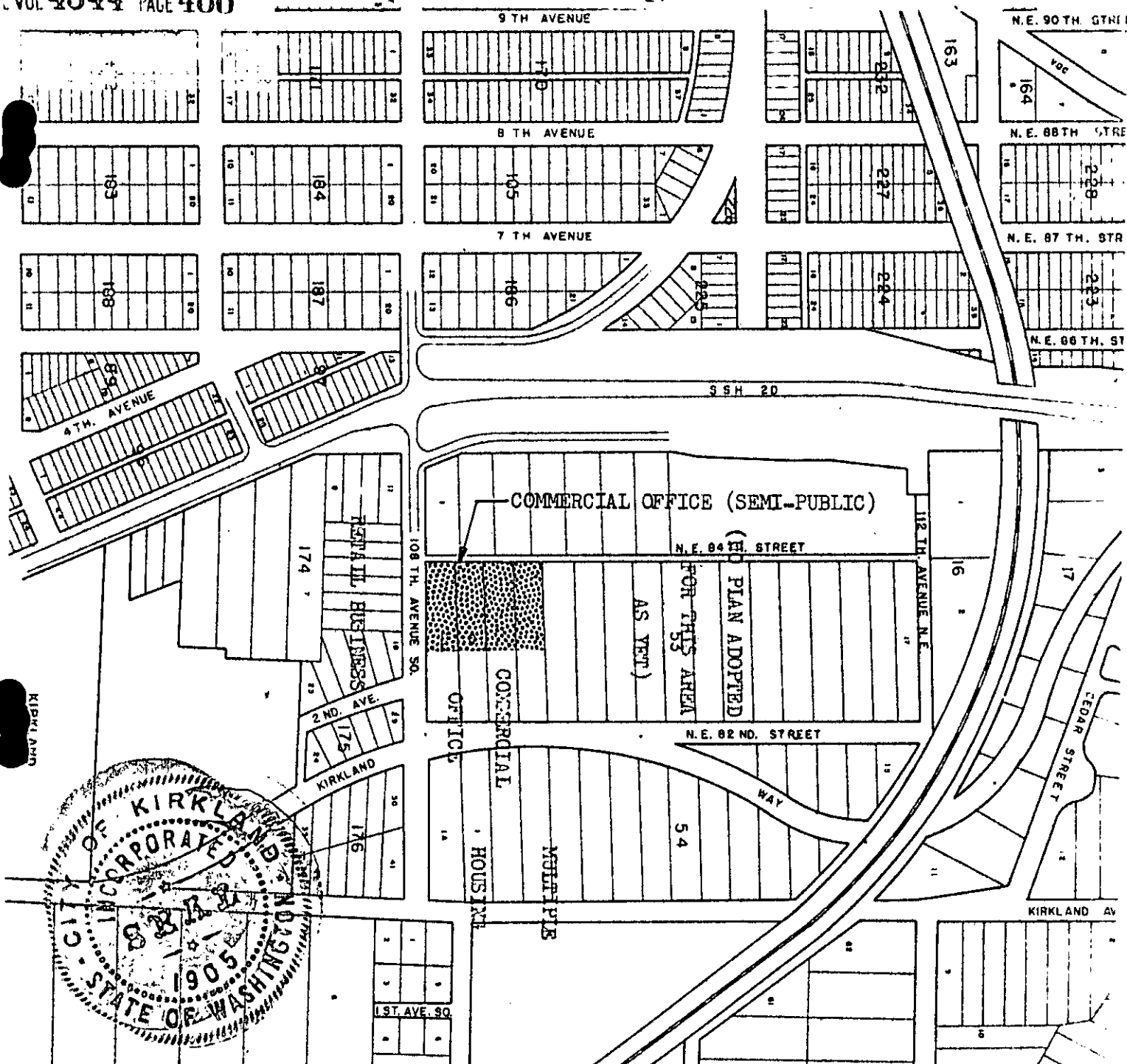

MAP OF AN AMENDMENT TO THE COMPREHENSIVE PLAN MAP OF THE CITY OF KIRKLAND RECOMMENDED FOR ADOPTION THE 4<sup>th</sup> DAY OF MAY, 1967, BY THE KIRKLAND PLANNING COMMISSION.

[Signature]  
SECRETARY PRO-TEM

[Signature]  
CHAIRMAN

PASSED AND APPROVED AS ORDINANCE NO. 1089 OF THE CITY OF KIRKLAND, ENTITLED, "AN ORDINANCE OF THE CITY OF KIRKLAND AMENDING THE COMPREHENSIVE PLAN MAP OF THE CITY OF KIRKLAND ASADOPTED IN ORDINANCE NO. 930", ADOPTED THE 5<sup>th</sup> DAY OF JUNE, 1967.

ATTEST: [Signature]

[Signature]  
MAYOR

Filed for Record June 14 1967 2:08 PM  
Request of City of Kirkland  
ROBERT A. MORRIS, County Auditor