

ORDINANCE NO. 1046

AN ORDINANCE OF THE CITY OF KIRKLAND AMENDING THE COMPREHENSIVE PLAN MAP OF THE CITY OF KIRKLAND AS ADOPTED IN ORDINANCE NO. 930.

WHEREAS, the Kirkland Planning Commission after public hearing thereon held August 21, 1966, has recommended to the Kirkland City Council that the Comprehensive Plan Map for the City of Kirkland be amended as hereinafter set forth, and

WHEREAS, the City Council of the City of Kirkland did hold on the 3rd day of October, 1966, a public hearing to consider said recommendation, and following said hearing did concur in the recommendation of the Kirkland Planning Commission.

NOW, THEREFORE, be it ordained by the City Council of the City of Kirkland as follows:

Section 1. The Comprehensive Plan Map of the City of Kirkland as adopted as a part of the Comprehensive Plan for the City of Kirkland by Ordinance No. 930 is hereby amended to show the recommended land use for all of the following described property to be multiple housing:

Beginning at the intersection of the center line of Kirkland Avenue with the west margin of Lake Street South; thence southwesterly along the center line of Kirkland Avenue a distance of 108.05 feet to the true point of beginning as herein established; thence, $S19^{\circ}19'36''E$ to the intersection of the south margin of Kirkland Avenue; thence, continuing along a line $S19^{\circ}19'36''E$ a distance of 99.21 feet; thence, $S18^{\circ}28'11''E$ a distance of 526 feet to the intersection of said line with the south line of Tax Lot 87; thence, $N58^{\circ}09'38''E$ to the intersection of the projection of said south line with the center line of Lake Street South; thence, southerly along said center line to the intersection of said center line with the south city limits of the City of Kirkland; thence, due west along the city limits to the intersection of said limits with the Outer Harbor Line of Lake Washington; thence, northerly and northwesterly along the Outer Harbor line of Lake Washington to the intersection of said line with the projection of the center line of Kirkland Avenue; thence, northeasterly along said projection of the center line of Kirkland Avenue and the centerline of Kirkland Avenue to the true point of beginning; except the Kirkland South City Beach Park. All in Kirkland, King County, Washington.

Section 2. The City Manager is hereby directed to cause such amended map to be prepared, certified and filed with the City Clerk and with the King County Auditor.

Section 3. This ordinance shall take effect five (5)

days from and after its passage by the council and publication as required.

PASSED by the Kirkland City Council in regular meeting on the 3rd day of October, 1966.

SIGNED in authentication thereof on the 3rd day of October, 1966.

James L. Vaux
Mayor

Attest:

Oliver Lucas
Director of Administration and Finance
(ex officio City Clerk)

Approved as to form:

Ralph E. Stone
City Attorney

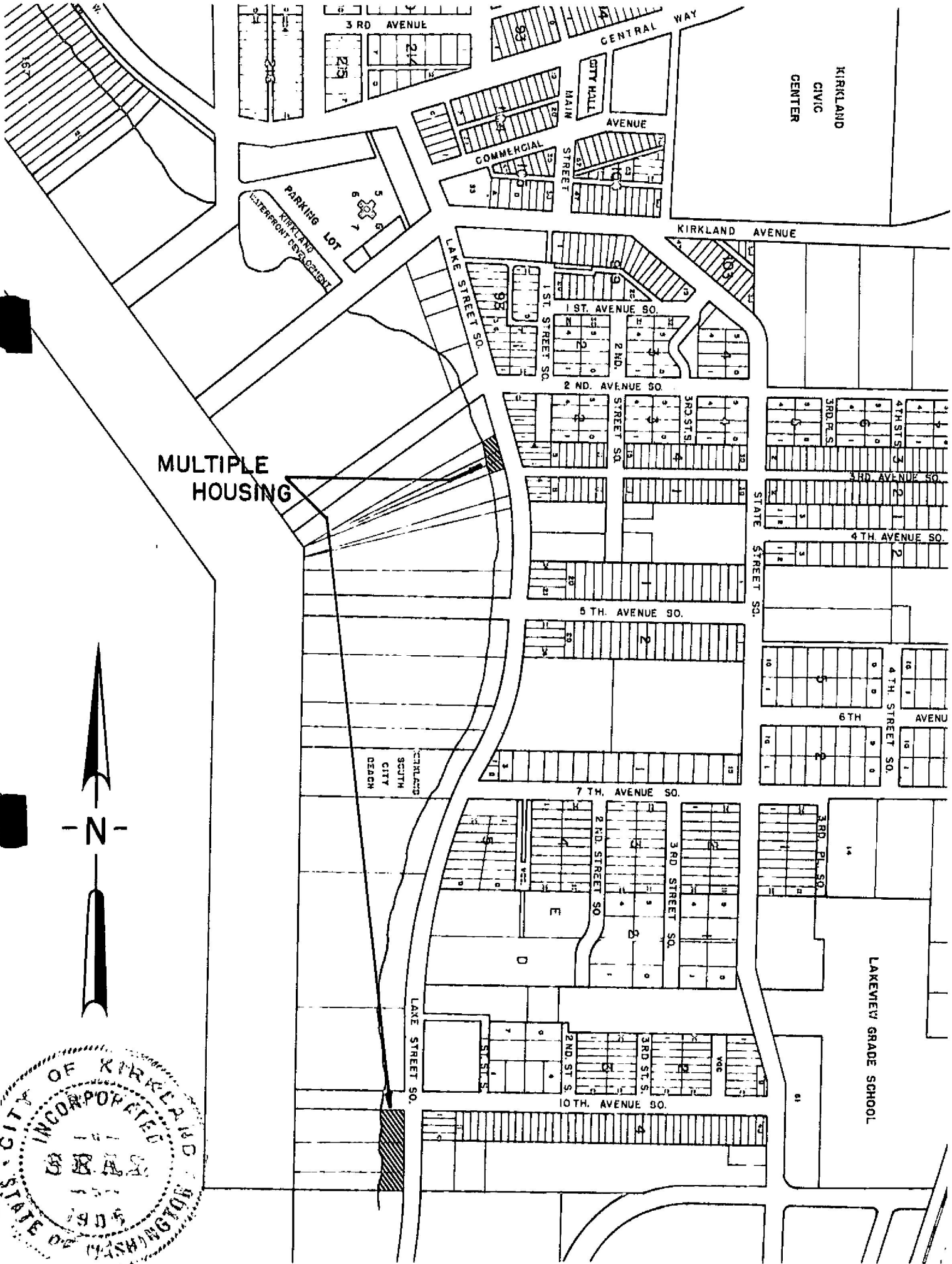

MAP OF AN AMENDMENT TO THE COMPREHENSIVE PLAN MAP OF THE CITY OF KIRKLAND RECOMMENDED FOR ADOPTION THE 21st DAY OF July, 1966, BY THE KIRKLAND PLANNING COMMISSION.

[Signature]
SECRETARY PRO-TEM

[Signature]
CHAIRMAN

PASSED AND APPROVED AS ORDINANCE NO. 1046 OF THE CITY OF KIRKLAND ENTITLED, "AN ORDINANCE OF THE CITY OF KIRKLAND AMENDING THE COMPREHENSIVE PLAN MAP OF THE CITY OF KIRKLAND AS ADOPTED IN ORDINANCE NO. 930", ADOPTED THE 31st DAY OF October, 1966.

ATTEST:
[Signature]

[Signature]
MAYOR